



Description

The K-array Kobra-KK102 I is a passive speaker system comprised of sixteen 2" neodymium magnet transducers housed in an elegant and sturdy stainless steel chassis. The vertical dispersion pattern can be switched for wide or narrow coverage, allowing for a great variety of applications. The sixteen closely spaced cone drivers provide true line array characteristics - phase coherence, low distortion and focused listening in both the near field, and at a distance from the speaker. A variety of rigging accessories provides many linking and hanging options for the KK102 I (1 meter) and the smaller (0.5 meter) KK52 I to be combined in vertical and horizontal line array configurations to satisfy many different venue requirements during temporary events and for permanent installations.

For easier use and integration with other speakers or amplifiers, the KK102 I allows the user to select two different values of impedance (8Ω – 32Ω). At 32Ω as many as 8 KK102 I speakers can be powered off a single amplifier channel at 4Ω. The KK102 I is able to reproduce the whole vocal frequency range with high intelligibility, starting from 150 Hz. Integrating one of K-array powered subwoofers (KMT12, KMT18, KMT21, KMT218), configured with specific presets for the KK102 I assures excellent coverage of the entire musical frequency range. The K-array KA amplifier series have pre-presets optimized for KK102 I use. All KK102 I components are designed by the K-array R&D department and custom-made under the K-array quality control system.

Colors		Premium Finishes		Features		Frequent Applications	
Black	●	Gold	●	Pure Array Technology (PAT)	Modular Capabilities	Auditorium, Education & Government	Event Productions
White	●	Polished	●	Weather Resistant	Selectable Coverage	Theaters & Concert Halls	Broadcast & Studios
RAL	●	Brushed	●	Selectable Impedance	EN54-24 Certified	Stadiums & Sport Venues	Retail

Accessories						
K-BASE2	K-FLY2	K-FOOT2	K-JOINT2	K-WALL2	K-WALL2L	KK-STAGE
K-IP65KITA	K-IP65KITB	K-KCLAMP	K-KCLAMP/S	K-PMOUNT	KK-CLUSTER	

Technical Specifications

General	
Type	Line array
Transducers	16 x 2" neodymium magnet woofers
Frequency Response ¹	150 Hz – 18 kHz (-6 dB)
Max SPL ²	126 dB (peak)
Rated Power	400 W
Coverage	V. 7° - 35° H. 120°
Connectors	SpeakOn NL4: 1+ 1- (signal); 2+ 2- (through)
Nominal Impedance	8 Ω / 32Ω selectable

Handling & Finishes	
Dimensions (WxHxD)	59 x 1000 x 81 mm (2.3 x 39.4 x 3.2 in)
Weight	4,8 kg (10.6 lb)
Material	Stainless Steel
Colors	Black, White, Custom RAL
Finishes	Gold, Polished, Brushed

Regulations	
IP Rating	IP64 ³
EN54-24	EN 54-24:2008 compliant ⁴

Accessories	
Recommended Amplifier	Kommander-KA24, Kommander-KA84, Thunder-KMT12, Thunder-KMT18
Accessories	K-BASE2, K-FLY2, K-FOOT2, K-IP65KITA, K-IP65KITB, K-JOINT2, K-KCLAMP, K-KCLAMP/S, K-WALL2, K-WALL2L, KK-STAGE, KK-CLUSTER, K-PMOUNT

¹ With dedicated preset

² Maximum SPL is calculated using a signal with crest factor 4 (12dB) measured at 8 m then scaled at 1 m

³ More complete water protection with K-IP65KITA and K-IP65KITB accessories (IP65 compliant)

⁴ See specification for EN 54-24 applications in products user's guide

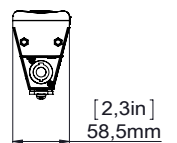
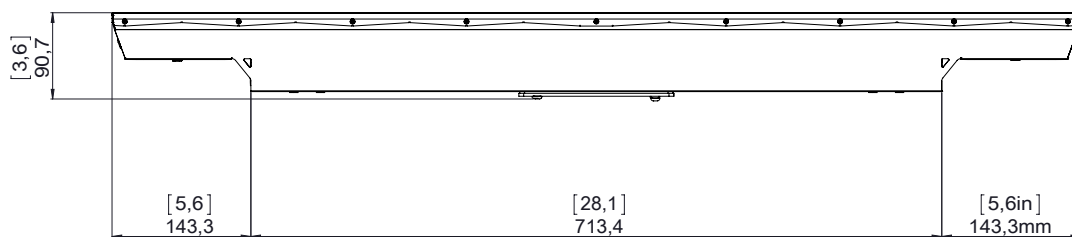

Notes for data:

Passive loudspeakers require dedicated presets loaded onboard K-array amplifiers.
 New materials and designs are introduced into existing products without previous notice.
 Present systems may differ in some respects from those presented in this catalog.

